

# Saudi Medicare 2010



**12 - 15  
April 2010**

The 13th International Healthcare, Hospital Supplies & Medical Equipment Show

Held Concurrently with:

**Saudi Dentistry 2010 • Saudi Eyecare 2010**

Riyadh International  
Exhibition Center

**Reserve the best available space... Reply now for Priority Attention!**

Tel: +966 1 2295604 • Fax: +966 1 2295612 • E-mail: info@recexpo.com

## OPTION 1

Inside Space Only (Minimum Space - 21 sqm.)  
**US\$ 320 per m<sup>2</sup>**

Power supply is charged separately.

## OPTION 2

Inside Space with Standard  
Package (Minimum Space - 9 sqm.)  
**US\$ 390 per m<sup>2</sup>**



Perspective View

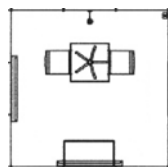

- 3 spot lights
- 1 Power outlet
- 1 Counter
- 2 Chairs
- 1 Table
- Fascia name board

## OPTION 3

Outside Space Only (Minimum Space - 30 sqm.)  
**US\$ 200 per m<sup>2</sup>**

Power supply is charged separately.

## Space & Standfitting requirements:

Please choose one:

Space Type	Cost	Size	Total
Option 1	US\$ 320 / m <sup>2</sup>	x m	
Option 2	US\$ 390 / m <sup>2</sup>	x m	
Option 3	US\$ 200 / m <sup>2</sup>	x m	

Name \_\_\_\_\_

Job Title \_\_\_\_\_

Company \_\_\_\_\_

Address \_\_\_\_\_

Country \_\_\_\_\_

Tel. \_\_\_\_\_

Fax \_\_\_\_\_

E-mail \_\_\_\_\_

Website \_\_\_\_\_

Product / Activity \_\_\_\_\_

Date \_\_\_\_\_

Signature \_\_\_\_\_

Fax your Space Option Form to your Country Coordinator or the Organizers

**HABIB ALPHONSE**

**Riyadh Exhibitions Co. Ltd.**

P.O. Box 56010, Riyadh 11554, KSA

Tel: +966 1 2295604 ext. 237 • Fax: +966 1 2295612

Mobile: +966 508406189

E-mail: habib.alphonse@recexpo.com

**www.saudi-medicare.com**